

T H E N E S S E E C O U N T Y

ITEM NO. L-723 PROPOSED NEW LEVEE AND LANDSIDE BERM STA. 254+50 TO STA. 350+00 1,076,000 CU. YDS.

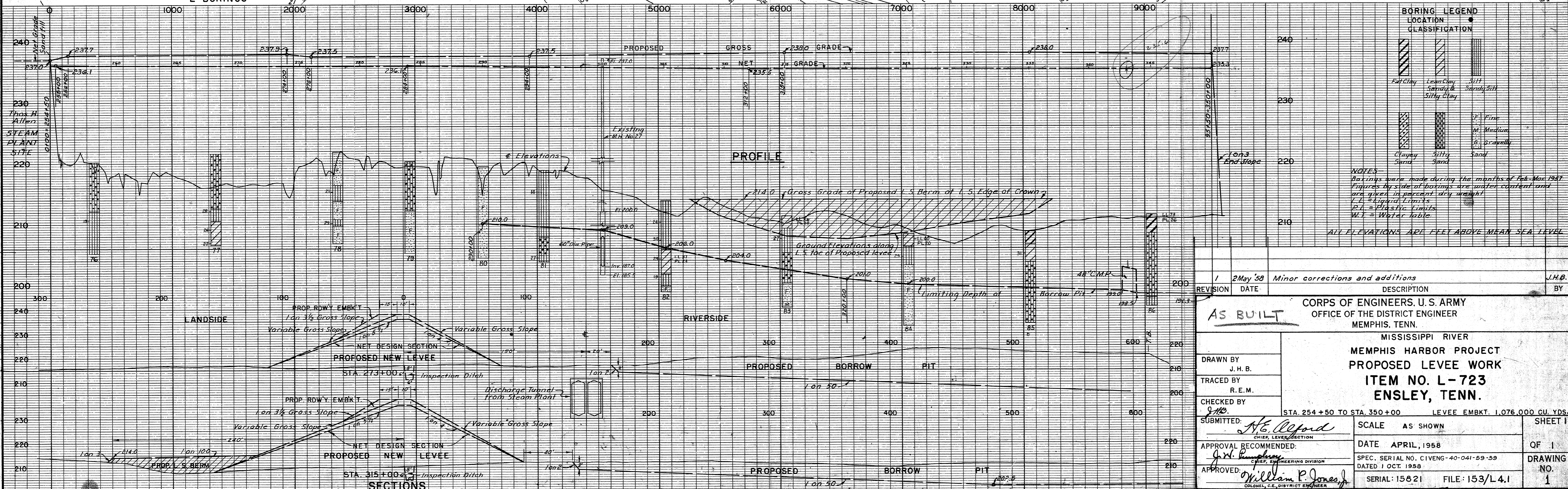
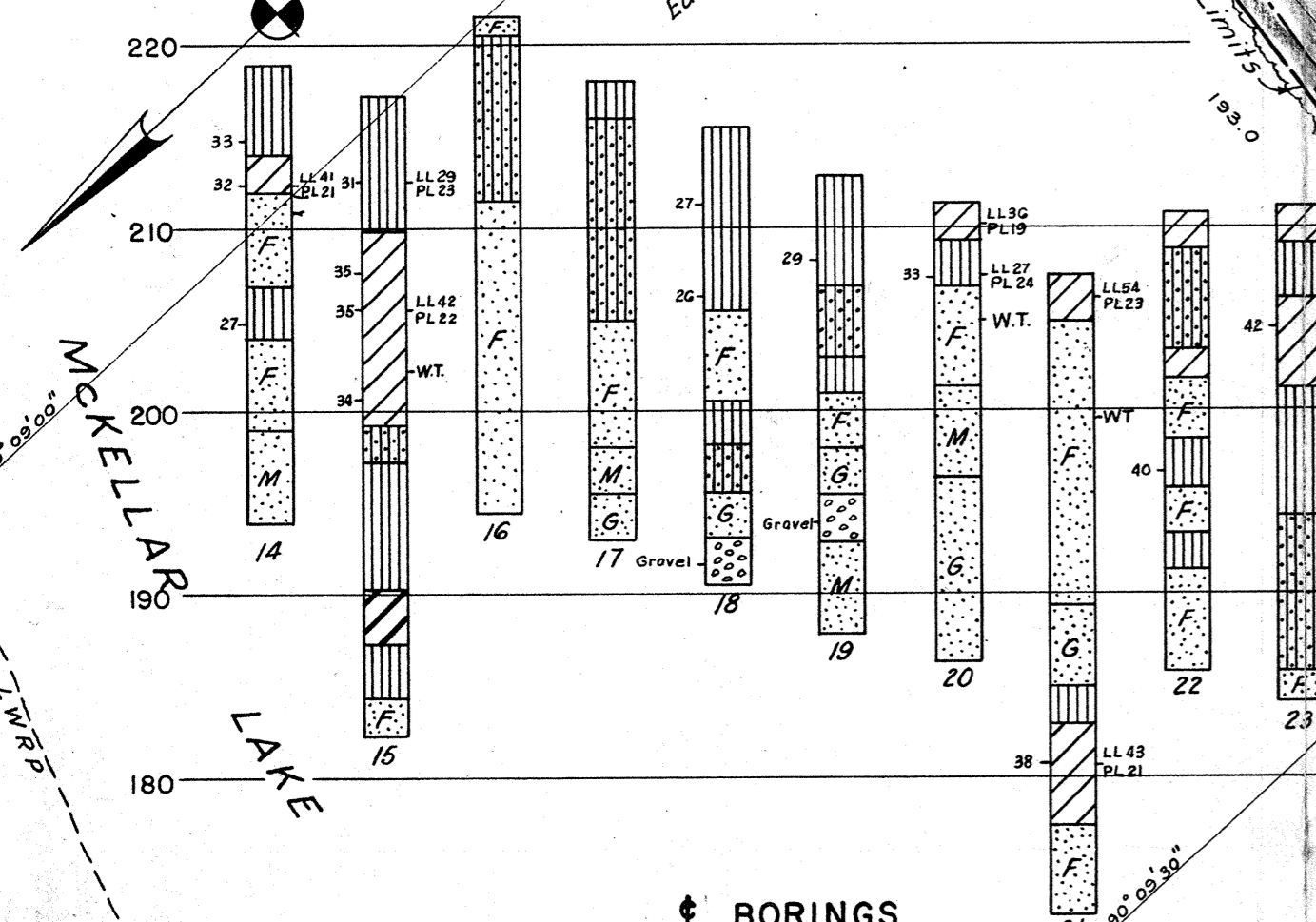
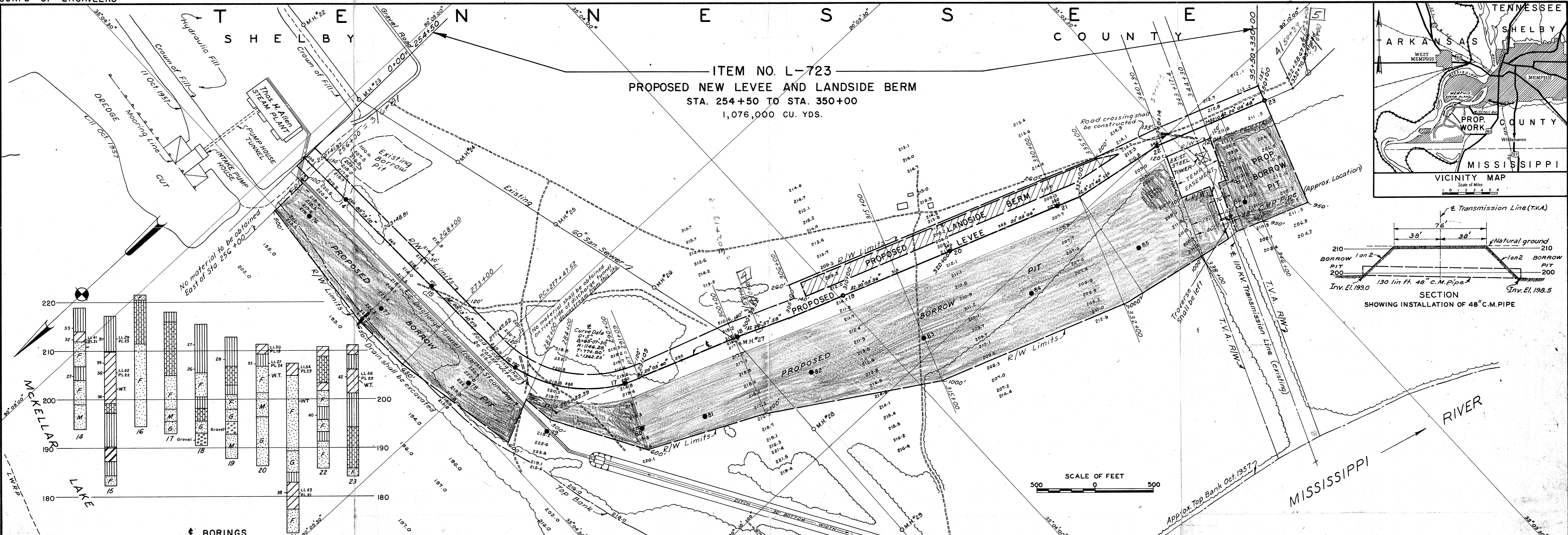
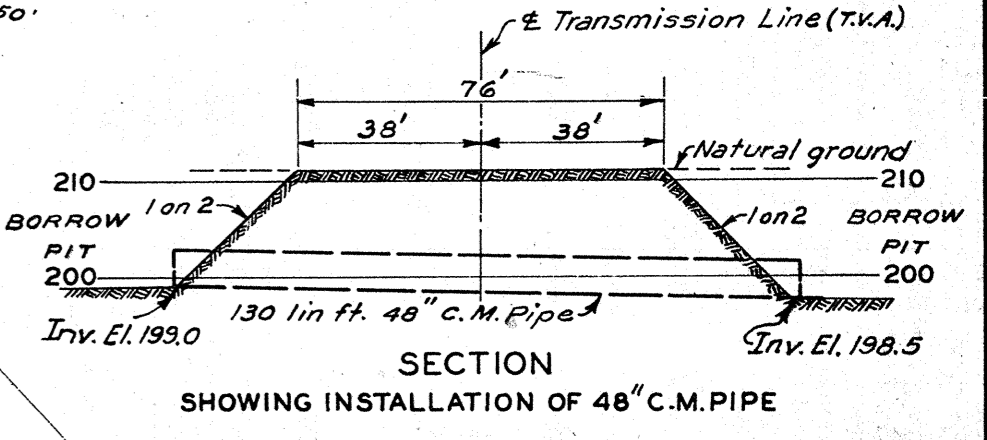
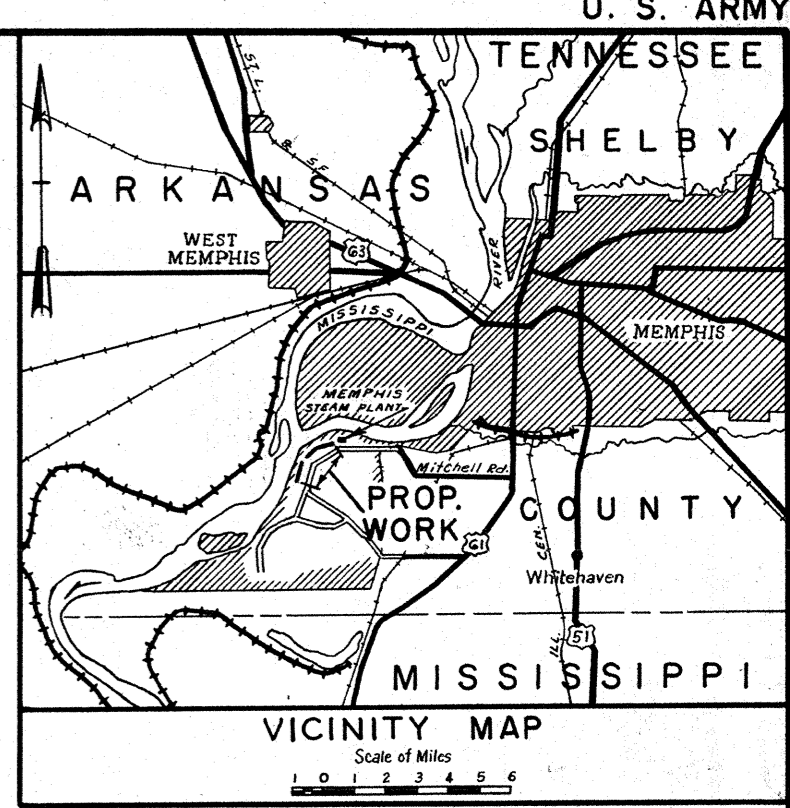

BORING LEGEND

LOCATION CLASSIFICATION

- Fill Clay
- Lean Clay
- Silt
- Sandy Silt
- Silty Clay
- Fine Sand
- Medium Sand
- Coarse Sand
- Clayey Sand
- Silty Sand
- Sand

NOTES
Borings were made during the months of Feb-Mar 1957. Figures to side of borings are water content and are given in percent dry weight.
L & S = Liquid Limits
P.L. = Plastic Limits
W.T. = Water Table

ALL ELEVATIONS ARE FEET ABOVE MEAN SEA LEVEL

REVISION	DATE	DESCRIPTION	BY
1	2 May 58	Minor corrections and additions	J.H.B.

AS BUILT

CORPS OF ENGINEERS, U.S. ARMY
OFFICE OF THE DISTRICT ENGINEER
MEMPHIS, TENN.

MISSISSIPPI RIVER
MEMPHIS HARBOR PROJECT
PROPOSED LEVEE WORK
ITEM NO. L-723
ENSLEY, TENN.

DRAWN BY: J. H. B.
TRACED BY: R. E. M.
CHECKED BY: J. H. B.
SUBMITTED: *H. E. Cofford*
APPROVED: *William P. Jones, Jr.*

STA. 254+50 TO STA. 350+00 LEVEE EMBKT. 1,076,000 CU. YDS.

SCALE AS SHOWN
DATE APRIL, 1958
SPEC. SERIAL NO. CIVENG-40-041-59-59
DATED 1 OCT. 1958
SERIAL: 15821 FILE: 153/L.4.1

SHEET 1 OF 1
DRAWING NO. 1

57715

FILE 153/L-46